



# Pigeon Corner Plans

Since last autumn the Local Agenda 21 Partnership has been holding meetings to discuss the refurbishment of the area around the Budgens and Iceland stores. As reported in last month's ARCHER, a set of plans covering three concepts for the development of the area entitled "East Finchley Town Square" have been drawn up.

These plans are to be put on public display so that people can see them, discuss them and vote on them. They will be on show in the following places:

East Finchley Library from Wednesday 15 May to Wednesday 29 May during library opening hours. You can vote on them there.

Finchley Youth Theatre on Wednesday 22 May from 11am to 2pm and from 8pm to

9.30pm. Landscape architects from Barnet Council will be there to answer any questions.

Readers can study the plans on this page at their leisure.

**Please vote for your preferred improvements by using the form at the bottom of the page.**

*Drawings reproduced by kind permission of the Landscape Team, London Borough of Barnet. © 2002 Landscape Team, LB Barnet.*

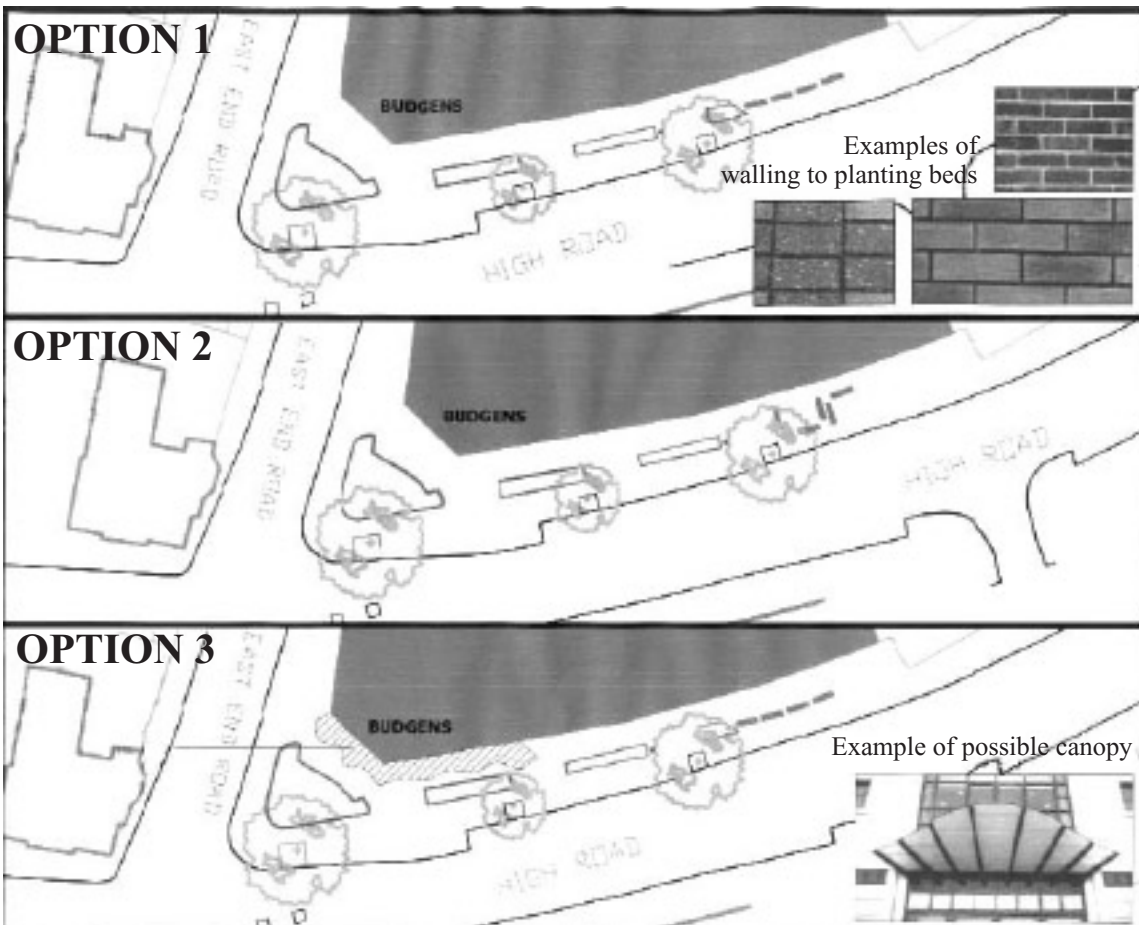
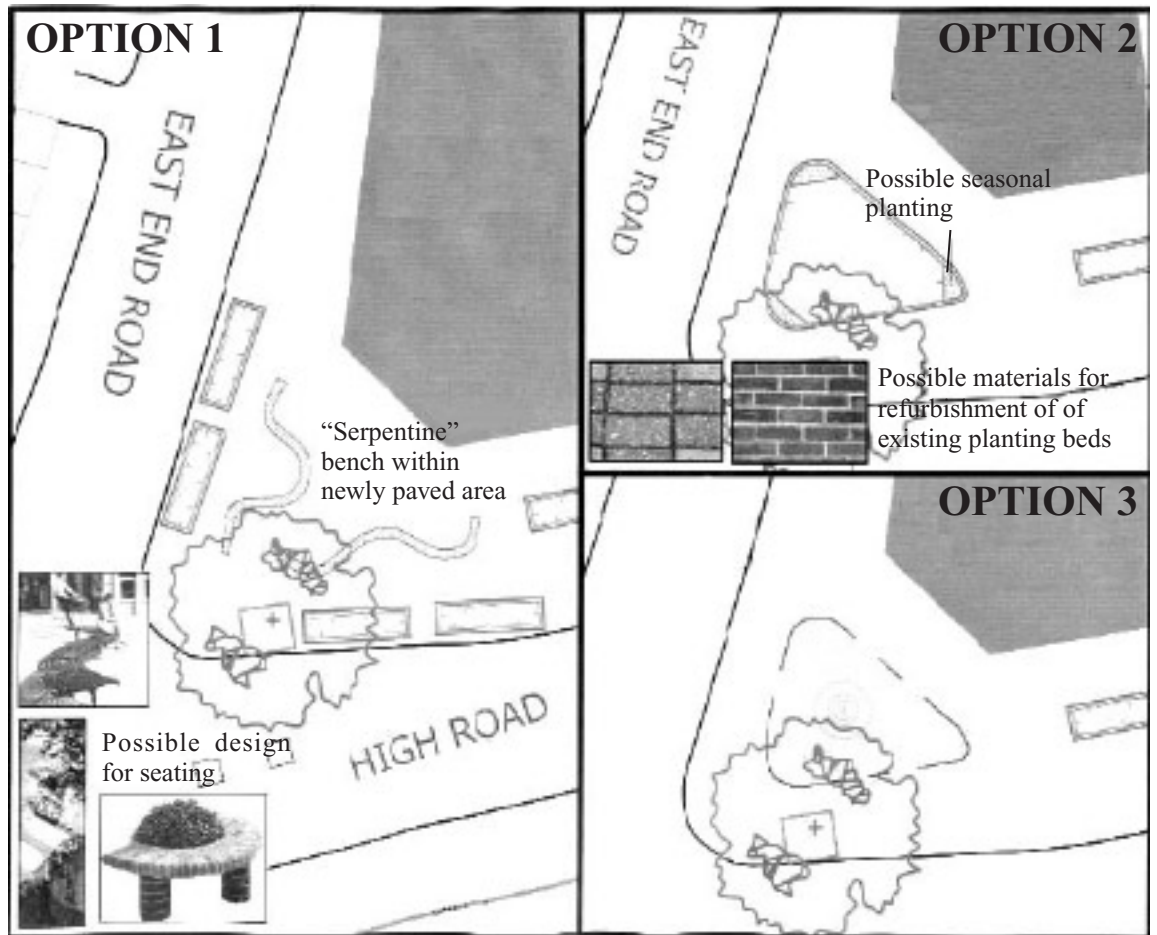

## Pigeon Corner (above)

**Option 1:** Re-shape corner planting bed and construct planters on the perimeter of the corner.

**Option 2:** Re-shape and refurbish corner bed. Upgrade existing low railing and safety barrier.

**Option 3:** Sculpture and/or water feature, without standing water pool. Main theme: Archer

## Along The High Road (left)

**Option 1:** Keep planting beds as existing but refurbish and enhance visual appearance with new materials.

**Option 2:** Remove smaller existing planting bed and replace with more seating.

**Option 3:** Create shelter and protection from rain by building a canopy along the length of the site. This option can be included with option 1 or 2.

## Along East End Road (below)

**Option 1:** Build intermittent kerbside planters (shown). Alternatively, build planters along Budgens' wall.

**Option 2:** Possible addition of trees. Exact positions and number of trees are subject to underground services.

**Option 3:** Along Budgens' wall plant climbers and seasonal planting in brick-built raised planters or in steel planting boxes. Alternatively design mural for Budgens' wall. Or, a combination of climbers, seasonal planting and mural.

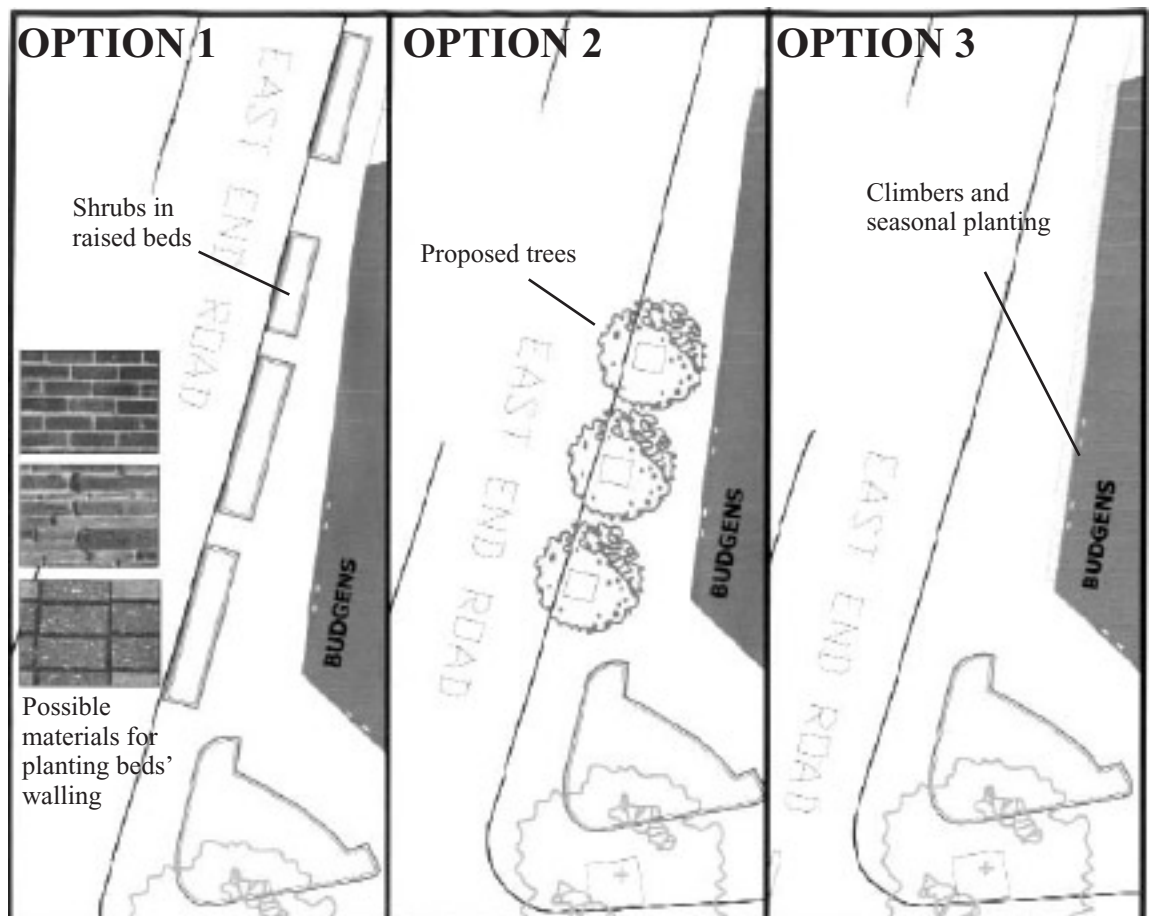

Have your say through The Archer...

### East Finchley "Town Square" improvements

Please tick only one option for each area:-

Options	1	2	3
Pigeon Corner			
Along the High Road			
Along East End Road			

Comments:

Please return this form by **Friday 31 May 2002** to:  
**Megan Williams, Landscape Architect,**  
**9th Floor, Barnet House,**  
**1255 High Road, Whetstone,**  
**London N20 0EJ. (Tel: 020 8359 4469).**